



Background

- Lhasa, China is located in the Tibet region, within the Himalayan Mountains.
- Majority of population consists of farmers and herdsman, all of which live in poverty.
- Currently live in run down, small, and weak structures.
- Need an affordable home capable of housing a single family.
- The land available is located on the side of neighboring mountains.



Abstract

The goal of the project is to provide the people of Lhasa, China with affordable housing. The housing must be designed to withstand nature and remain at the lowest cost possible while still creating a strong and permanent home for the people of Lhasa, China.



Main components of the Home



Activity Number:	Activity:	W 1		W 2		W 3		W 4		W 5		W 6		W 7		W 8		Duration (Days)	Cost Per Days (US\$)	Cost Estimate (US\$)	Total (US\$)
		M	T	W	R	F	M	T	W	R	F	M	T	W	R	F	M				
1	Design Presentation to Locals																	3	\$100.00	\$300.00	\$7,815.00
2	Site Layout/Plot Land																	2	\$0.00	\$0.00	
3	Importation of materials																	10	\$50.00	\$500.00	
4	Clearing of area																	3	\$80.00	\$240.00	
5	Concrete Foundation/Basement																	3	\$200.00	\$600.00	
6	Concrete Stairs																	2	\$100.00	\$200.00	
7	Frame of First Floor																	2	\$200.00	\$400.00	
8	Frame of Second Floor																	2	\$200.00	\$400.00	
9	Floor Construction																	3	\$167.00	\$500.00	
10	Walls of First Floor																	2	\$150.00	\$300.00	
11	Walls of Second Floor																	2	\$150.00	\$300.00	
12	Roof																	2	\$75.00	\$150.00	
13	Insulation																	1	\$100.00	\$100.00	
14	Plumbing																	4	\$250.00	\$1,000.00	
15	Windows																	1	\$1,000.00	\$1,000.00	
16	Drywall																	2	\$200.00	\$400.00	
17	Wood Stove																	1	\$600.00	\$600.00	
18	Small Kitchen																	2	\$250.00	\$500.00	
19	Siding																	1	\$100.00	\$100.00	
20	Stairs																	3	\$75.00	\$225.00	
21	Final Checks/Move in																	2	\$0.00	\$0.00	

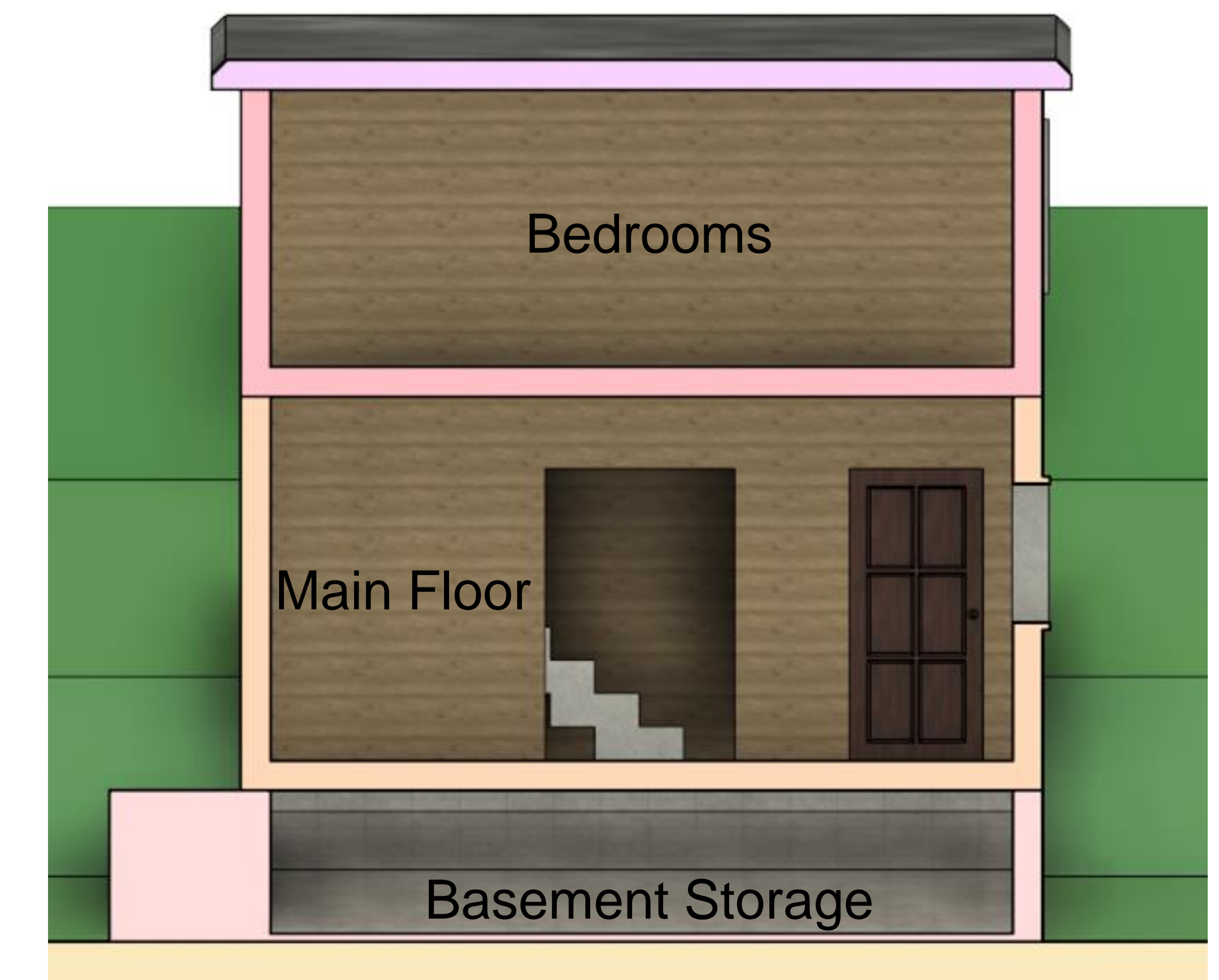

Floor Plan

- The first floor is the main living space where cooking, eating, and lounging occurs.
- Second floor is mainly used for sleeping.

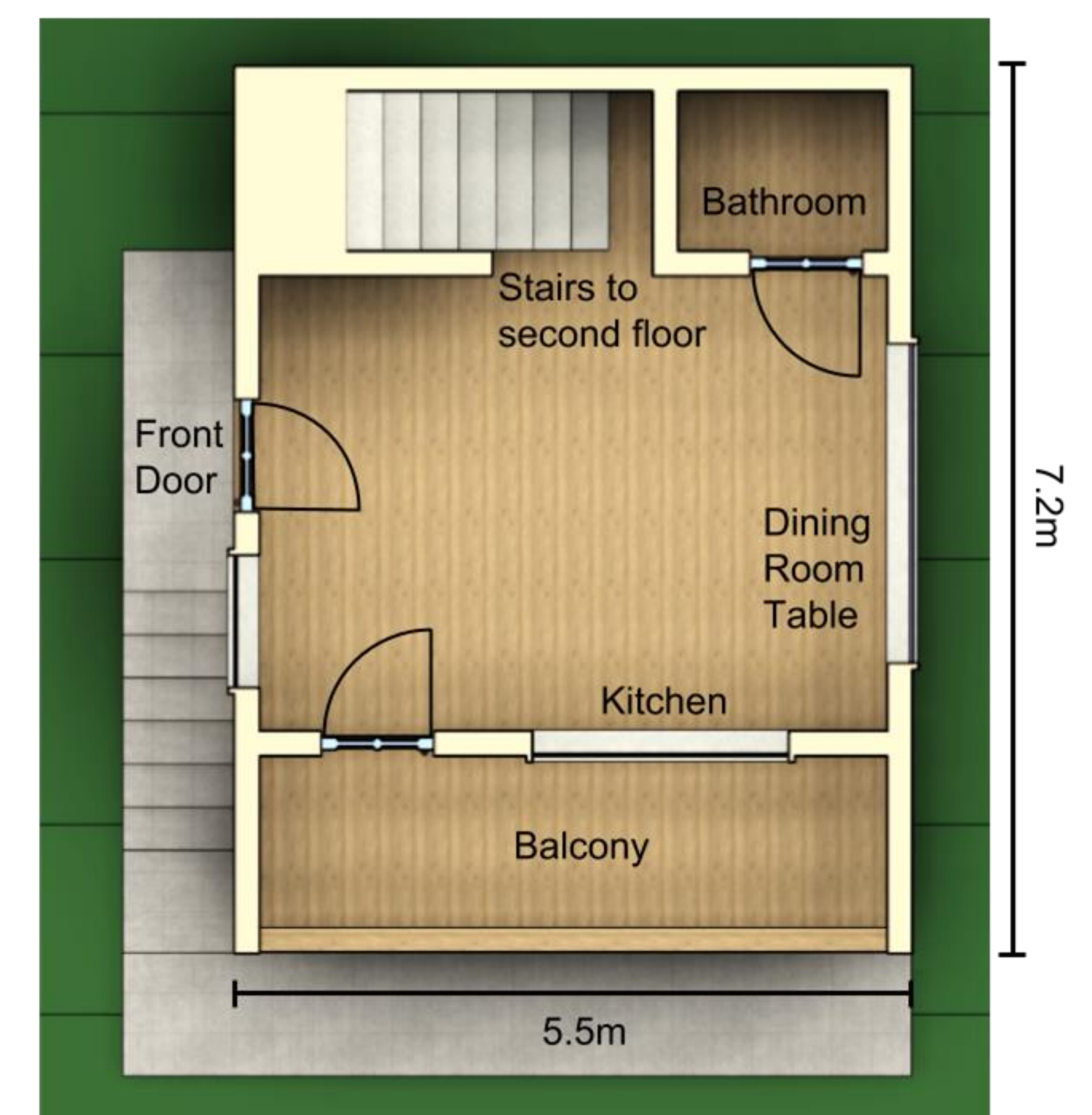

The overall cost would total \$7,815.00